



U-Flow Air Filter Kit

Part# 430-KLX-1110

BBR U-Flow air filter kit is designed to work with OEM, 26mm Mikuni, or a 28mm Keihin Carburetor.

For some applications jetting changes may be needed. See second page for details.

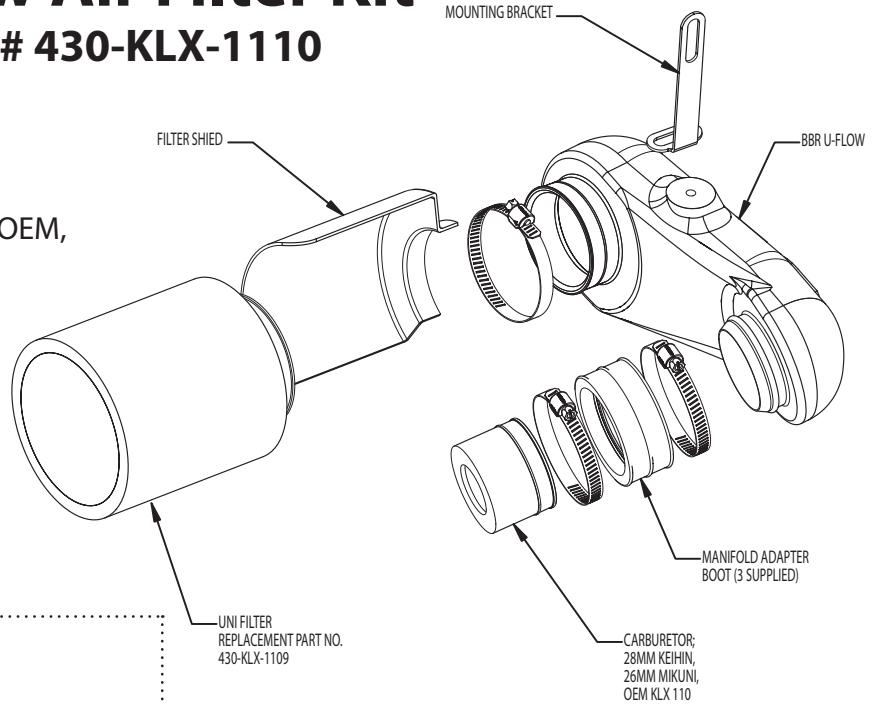

Installation:

1. Remove stock airbox assembly
2. Determine which manifold adapter boot you will need. (See Fig.1)
3. Install boot to carb. Secure with supplied hose clamp. Note: If using OEM carb you must cut off choke guard. (See Fig. 2 and 3)
4. Install BBR U-Flow onto boot. Secure with supplied hose clamp. (See Fig. 4)
5. OEM frame installation only:(See Fig. 5)
 - Install mounting bracket to U-Flow with supplied bolt and washer. (DO NOT OVERTIGHTEN)
 - Install bracket to frame with supplied bolt.
 - Bracket can be bent for multiple mounting positions.
6. Mounting bracket may be used on aftermarket frames. Locations will vary based frame type, may need to drill and tap M6 X 1.0 hole. (MOUNTING BRACKET IS OPTIONAL)
7. Install UNI air filter and filter shield. Secure with UNI hose clamp. (Replacement filter BBR Part# 430-KLX-1111) (Filter shield is optional and can be rotated to any position.)

**Optional bracket for OEM Shroud mount is available through BBR Motorsports. (Part# 430-KLX-1109)

Fig. 1



Fig. 2



Fig. 3



Fig. 4

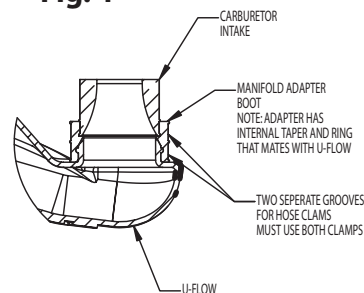

Fig. 5



For More Information:

TOLL FREE: (888) 668-6227 Int'l: (253) 631-8233 FAX: (253) 631-4260

****Note** Jetting Specs for U-Flow Air Filter **Note****

Colder weather requires larger jets. Warmer weather and higher octane require smaller jets.

92 octane @ sea level (60 degrees)

Stock KLX 110 = OEM Stock Carb and OEM Pipe (95-100 main jet)

Stock KLX 110 = OEM Stock Carb and BBR Pipe (100 -105 main jet)

KLX 110 Stock Carb 143cc Kit = (100-105 main jet)

KLX 110 Stock Carb 143cc Kit and BBR Pipe = (105 and up main jet)

KLX 110 143cc Kit, 26mm Mikuni Carb and BBR Pipe = (180 main jet, 22.5 Pilot)

KLX 110 160cc Kit, 26mm Mikuni Carb and BBR Pipe = (190 main jet, 22.5 Pilot)

KLX 110 160cc+ Kit, 28mm Kiehn Carb and BBR Pipe = (120 main jet, 42 Pilot)